



Florida Department of Environmental Protection

Southwest District Office
13051 North Telecom Parkway
Temple Terrace, Florida 33637-0926

Charlie Crist
Governor

Jeff Kottkamp
Lt. Governor

Michael W. Sole
Secretary

June 12, 2009

**CERTIFIED MAIL 7008 0150 0003 4894 3088
RETURN RECEIPT REQUESTED**

Robert M. Bedard
Assistant Vice President
Wal-Mart Stores East, Inc.
2001 SE 10th Street
Bentonville, Arkansas 72716-0550

RE: Site Rehabilitation Completion Order – No Further Action without Controls
Wal-Mart Gunn Highway Brownfield Site
6192 Gunn Highway, Tampa,
Hillsborough County, Florida
Brownfield Site No. BF 290202001
OGC No. 93-0225
WCU Site No. COM_65078
WCU Project No. COM_65892

Dear Mr. Bedard:

The Department has reviewed the Site Rehabilitation Completion Report (SRCR) with request for No Further Action (NFA), dated February 5, 2009, received February 6, 2009. The SRCR was prepared by The Colinas Group, Inc., on behalf of Wal-Mart addressing groundwater contamination at the Wal-Mart Gunn Highway Brownfield Site, located at 6192 Gunn Highway, Tampa, Hillsborough County, Florida. Maps showing the location of the property and the location of Monitoring Wells and location of former soil contamination for which this Order is being issued are attached as Exhibit 1 and 2 are incorporated by reference herein.

The contamination, which resulted from a discharge that was reported in 1981 to the United States Environmental Protection Agency, consisted of volatile organic compounds including acetone, benzene, butyl benzyl phthalate, carbontetrachloride, chlorobenzene, 1,2-dichlorobenzene, 1,2-dichloroethane, cis-1,2-dichloroethene, chromium, 1,2-dichloropropane, ethylbenzene, lead, styrene, tetrachloroethene, toluene, 1,1,1-trichloroethane, trichloroethene, vinyl chloride, and xylenes. The discharge

resulted from the disposal of paint wastes at the former Mary Carter Industries property, which forms a portion of the Wal-Mart Gunn Highway Brownfield Site. The Brownfield Site Rehabilitation Agreement (BSRA), BF290202001 (hereinafter "*the Agreement*") was executed by the Department on November 6, 2002, to address the contamination. The SRCR with NFA Proposal is supported by, but not limited to earlier submittals, prepared pursuant to the requirements of Chapter 62-785, Florida Administrative Code (F.A.C.):

- Contamination Assessment Plan Addendum, dated March 22, 1993 (received March 23, 1993).
- Contamination Assessment Report Addendum I, dated May 17, 1994 (received May 26, 1994).
- Remedial Action Plan, dated July 24, 1996 (received July 31, 1996).
- First Quarterly Groundwater Monitoring Report, dated April 1, 2002 (received April 2, 2002).
- Report Groundwater Remediation, First Semi-Annual Groundwater Monitoring Report, dated January 3, 2005 (received January 4, 2005).
- Report Groundwater Remediation, Eighth Semi-Annual Groundwater Monitoring Report, dated August 11, 2008 (received August 14, 2008).

Based upon the information provided by Wal-Mart concerning property located at 6192 Gunn Highway, Tampa, Hillsborough County, Florida, it is the opinion of the Department that Wal-Mart has successfully and satisfactorily implemented the approved BSRA schedule and program tasks pursuant to Chapter 62-785, F.A.C. Site rehabilitation has addressed soil contamination per Rule 62-785.680(1)(b), F.A.C., and groundwater contamination per Rule 62-785.680(1)(c), F.A.C., with special emphasis on Rule 62-785.680(1)(b)2, F.A.C., whereby groundwater contaminant concentrations only exceed the GCTLs derived from nuisance, organoleptic, or aesthetic considerations and the following additional criteria are met:

- (a) Concentrations of contaminants meet all applicable health-based groundwater CTLs provided in Table I of Chapter 62-777, F.A.C., and Table A, if applicable, and surface water CTLs pursuant to paragraph 62-785.680(1)(d), F.A.C.;
- (b) Wal-Mart, as the Person Responsible for Brownfield Site Rehabilitation (PRFBSR), has demonstrated by a minimum of one year of groundwater monitoring data that groundwater concentrations at the property boundary do not and will not exceed the groundwater CTLs pursuant to subparagraph 62-785.680(1)(c)2., F.A.C.;

- (c) Wal-Mart, as the real property owner, has established that the property has access to and is connected to an off-site water supply for domestic purposes and private wells are not used for domestic purposes; and
- (d) Wal-Mart, as the real property owner, has provided written acceptance of the No Further Action Proposal to the Department.

The submittals indicate that all contaminants of concern (COCs) identified in the groundwater at the site are below the applicable Soil Cleanup Target Levels and Maximum Concentration Limits or Groundwater Cleanup Target Levels (GCTLs) as adopted in Chapter 62-777, F.A.C. Therefore, you have satisfied the site rehabilitation requirements for the above-referenced contaminated site and are released from any further obligation to conduct site rehabilitation at the contaminated site, except as set forth below. See attached tables (Exhibit 3), incorporated by reference herein, which includes information regarding the contaminants, affected media, and applicable cleanup target levels for the contaminated site that is the subject of this Order.

Failure to meet the following requirements will result in the revocation of this Order:

- (a) You are required to properly abandon all monitoring wells within 60 days of receipt of this Order. The monitoring wells must be plugged and abandoned in accordance with the requirements of Rule 62-532.500(4), F.A.C.; and

Further, in accordance with Chapter 376.82(3), Florida Statutes (F.S.), upon completion of site rehabilitation in compliance with sections 376.77 – 376.85, F.S., additional site rehabilitation is not required unless it is demonstrated that:

- (a) That fraud was committed in demonstrating site conditions or completion of site rehabilitation;
- (b) That new information confirms the existence of an area of previously unknown contamination which exceeds the site-specific rehabilitation levels established in accordance with section 376.81, F.S., or which otherwise poses the threat of real and substantial harm to public health, safety, or the environment in violation of the terms of sections 376.77-376.85, F.S.;
- (c) That the remediation efforts failed to achieve the site rehabilitation criteria established under section 376.81, F.S.;
- (d) That the level of risk is increased beyond the acceptable risk established under section 376.81, F.S. due to substantial changes in exposure conditions, such as a

change in land use from nonresidential to residential use. Any person who changes the land use of the brownfield site thus causing the level of risk to increase beyond the acceptable risk level may be required by the department to undertake additional remediation measures to assure that human health, public safety, and the environment are protected to levels consistent with section 376.81, F.S.; or

- (e) That a new release occurs at the brownfield site subsequent to a determination of eligibility for participation in the brownfield program established under section 376.80, F.S.

Legal Issues

The Department's Order shall become final unless a timely petition for an administrative hearing is filed under sections 120.569 and 120.57, Florida Statutes ("F.S."), within 21 days of receipt of this Order. The procedures for petitioning for a hearing are set forth below.

Persons affected by this Order have the following options:

- A. If you choose to accept the Department's decision regarding this SRCO you do not have to do anything. This Order is final and effective as of the date on the top of the first page of this Order.
- B. If you choose to challenge the decision, you may do the following:
 - 1. File a request for an extension of time to file a petition for hearing with the Department's Agency Clerk in the Office of General Counsel within 21 days of receipt of this Order; such a request should be made if you wish to meet with the Department in an attempt to informally resolve any disputes without first filing a petition for hearing; or
 - 2. File a petition for administrative hearing with the Department's Agency Clerk in the Office of General Counsel within 21 days of receipt of this Order.

Please be advised that mediation of this decision pursuant to section 120.573, F.S., is not available.

How to Request an Extension of Time to File a Petition for Hearing

For good cause shown, pursuant to Rule 62-110.106(4), Florida Administrative Code ("F.A.C."), the Department may grant a request for an extension of time to file a petition for hearing. Such a request must be filed (received) by the Agency Clerk in the Office of General Counsel of the Department at 3900 Commonwealth Boulevard, Mail Station 35, Tallahassee, Florida, 32399-3000, within 21 days of receipt of this Order. Petitioner, if different from the PRFBSR, shall mail a copy of the request to Mr. Robert M. Bedard, Wal-Mart Stores East, Inc., 2001 SE 10th Street, Bentonville, Arkansas 72716-0550 at the time of filing. Timely filing a request for an extension of time tolls the time period within which a petition for administrative hearing must be made.

How to File a Petition for Administrative Hearing

A person whose substantial interests are affected by this Order may petition for an administrative proceeding (hearing) under sections 120.569 and 120.57, F.S. The petition must contain the information set forth below and must be filed (received) by the Agency Clerk in the Office of General Counsel of the Department at 3900 Commonwealth Boulevard, MS 35, Tallahassee, Florida, 32399-3000, within 21 days of receipt of this Order. Petitioner, if different from the PRFBSR, shall mail a copy of the petition to Mr. Robert M. Bedard, Wal-Mart Stores East, Inc., 2001 SE 10th Street, Bentonville, Arkansas 72716-0550 at the time of filing. Failure to file a petition within this time period shall waive the right of anyone who may request an administrative hearing under sections 120.569 and 120.57, F.S.

Pursuant to subsection 120.569(2), F.S., and Rule 28-106.201, F.A.C., a petition for administrative hearing shall contain the following information.

- a) The name, address, and telephone number of each petitioner; the name, address, and telephone number of the petitioner's representative, if any; the site owner's name and address, if different from the petitioner; the DEP facility number (COM_65078); and the name and address of the facility;
- b) A statement of when and how each petitioner received notice of the Department's action or proposed action;
- c) An explanation of how each petitioner's substantial interests are or will be affected by the Department's action or proposed action;
- d) A statement of the disputed issues of material fact, or a statement that there are no disputed facts;
- e) A statement of the ultimate facts alleged, including a statement of the specific facts the petitioner contends warrant reversal or modification of the Department's action or proposed action;

- f) A statement of the specific rules or statutes the petitioner contends require reversal or modification of the Department's action or proposed action; and
- g) A statement of the relief sought by the petitioner, stating precisely the action petitioner wishes the Department to take with respect to the Department's action or proposed action.

This Order is final and effective as of the date on the top of the first page of this Order. Timely filing a petition for administrative hearing postpones the date this Order takes effect until the Department issues either a final order pursuant to an administrative hearing or an Order Responding to Supplemental Information provided to the Department pursuant to meetings with the Department.

Judicial Review

Any party to this Order has the right to seek judicial review of it under section 120.68, F.S., by filing a notice of appeal under rule 9.110 of the Florida Rules of Appellate Procedure with the Agency Clerk of the Department in the Office of General Counsel, Mail Station 35, 3900 Commonwealth Boulevard, Tallahassee, Florida 32399-3000, and by filing a copy of the notice of appeal accompanied by the applicable filing fees with the appropriate district court of appeal. The notice of appeal must be filed within thirty days after this order is filed with the clerk of the Department (see below).

Questions

Any questions regarding the Department's review of your SRCR should be directed to John Segó, P.G. at (813)-632-7600 x420. Questions regarding legal issues should be referred to Ms. Holly Cauley in the Department's Office of General Counsel at (850) 245-2242. Contact with any of the above does not constitute a petition for administrative hearing or request for an extension of time to file a petition for administrative hearing.

Mr. Robert M. Bedard
Wal-Mart Gunn Highway
Page 7 of 7

The FDEP Brownfield Site ID Number for this site is BF 290202001. Please use this identification on all future correspondence with the Department.

Sincerely yours,



Deborah Getzoff
District Director
Southwest District

FILING AND ACKNOWLEDGMENT

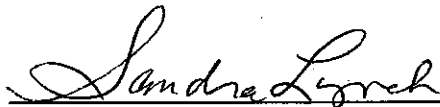
FILED, on this date, pursuant to §120.52 Florida Statutes, with the designated Department Clerk, receipt of which is hereby acknowledged.

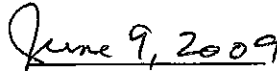

Clerk
(or Deputy Clerk)



Date

Enclosures

- Exhibit 1 – Map showing facility location
- Exhibit 2 – Maps showing the location of the former contaminated site
- Exhibit 3 – Most recent tables generated by the PRFBRS pursuant to subparagraph 62-785.680(4), F.A.C.

cc:  Brownfields Liaison, Tallahassee BWC
Holly Cauley, Brownfields Program Attorney, Tallahassee OGC
Jason Lichstein, Akerman Senterfitt
Mark Stephens, The Colinas Group, Inc.
File

EXHIBIT 1



3-D TopoQuad Copyright © 1999 DeLorme Yarmouth, ME 04896 Source Data: USGS 1:891 ft Scale: 1:24,000 Detail: 13-0 Datum: WGS84

<p>BUCKLEY SHULER LAND HOLDINGS LLC</p>	<p>DATE 02/28/02</p>	<p>JOB. NO. S-228G</p>	<p>PLATE NO. 1</p>
<p>THE COLINAS GROUP, INC. ENGINEERING AND ENVIRONMENTAL CONSULTANTS 2031 E. EDGEWOOD DRIVE - #5, LAKELAND, FLORIDA 33803 863-669-9141 - Fax 863-669-1742 LAKELAND . SARASOTA . WINTER PARK</p>		<p>SITE LOCATION MAP CITRUS PARK COMMONS HILLSBOROUGH COUNTY, FLORIDA</p>	

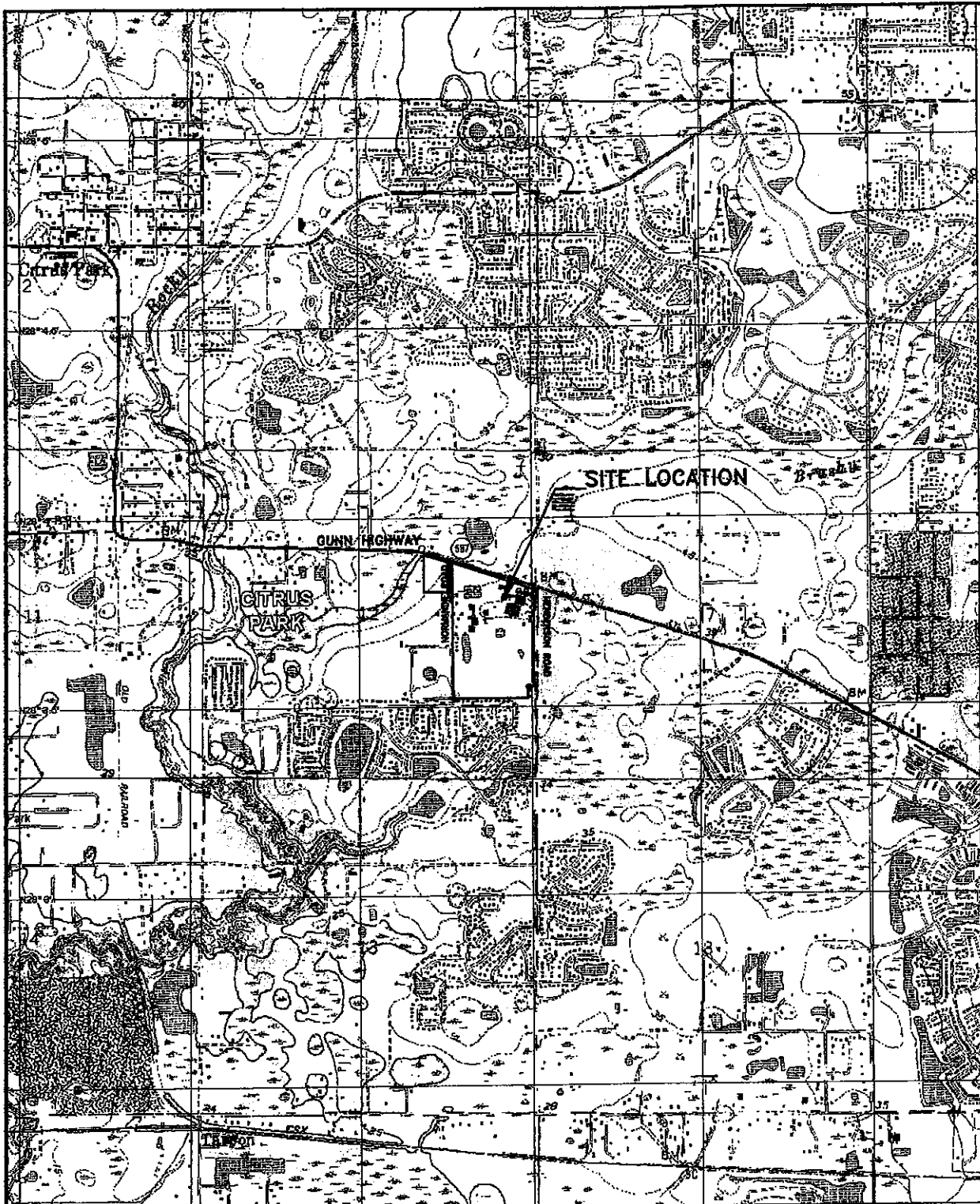
EXHIBIT 2

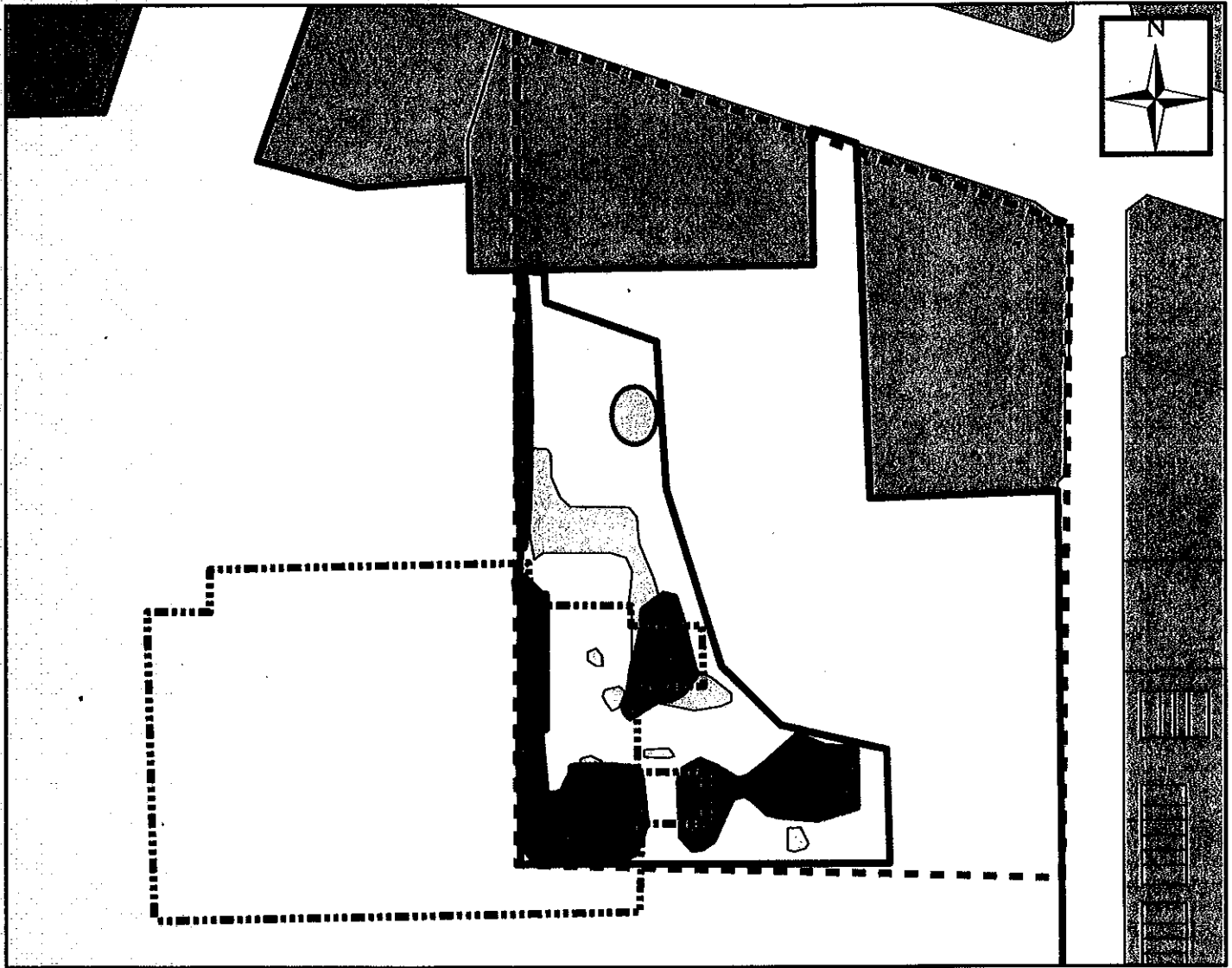

Legend

- Wal-Mart_Building
- █ Excavation_2001
- █ Excavation_1995
- █ Soil_stabilization
- █ Soil_Excavation_1990
- █ Soil_Excavation_1989
- WM_Buckley_Schuler_Contaminated_Soils
- - - Former_MCI_Property
- Wal-Mart_Gunn_Hwy_BrownField_Site
- █ Property_Parcel

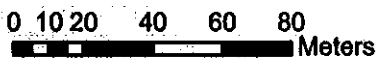

Exhibit 2

**Walmart Gunn Highway
Excavation Areas**

EXHIBIT 3

Table 4.2
 Analytical Results for Soil Samples
 Collected in February 1994 at the MCI Site
 Tampa, Florida

Parameter	Sample No. Date Sampled	SS-01 2/22/94	SS-02 2/22/94	SS-03 2/22/94	SS-04 2/22/94	SS-05 34987	SS-06 2/22/94	SS-7A 2/25/94
Volatiles Organic Compound (ug/Kg)								
cis-1,2-Dichloroethene		<	6.6	<	6.3	<	5.8	<
Benzene		<	6.1	<	6.3	<	5.8	<
Ethylbenzene		<	6.1	<	6.3	<	5.8	<
Toluene		<	6.1	<	6.3	<	5.8	<
Xylenes, Total		<	6.1	<	6.3	21,000 J	<	<
Metals (mg/kg)								
Cadmium		<	0.33	<	0.32	<	0.29	<
Chromium		8.7	3.8	12.5	7.4	4.2	5.8	<
Lead		4.9 J	1.0 J	3.3 J	15.5 J	3.0 J	3.7 J	1.3
Mercury		<	0.13	<	0.15	0.14	0.36	0.77 J

J Positive result has been classified as qualitative.
 UJ Analyte was not detected or has been classified as undetected,
 with further classification as qualitative.
 U Reported or classified as undetected.
 R Analyte result has been classified as unusable.

Table 4.2
 Analytical Results for Soil Samples
 Collected in February 1994 at the MCI Site
 Tampa, Florida

Parameter	Sample No. Date Sampled	SS-7B 2/25/94	DUP C 2/25/94	SS-8 2/23/94	SS-9 2/23/94	SS-10 2/23/94	SS-12 2/23/94	SS-13 2/23/94
Volatile Organic Compound (ug/Kg)								
cis-1,2-Dichloroethene	<	5.2	<	6.0	<	6.2	<	6.0
Benzene	<	5.2	<	6.0	50	6.2	6.1	6.0
Ethylbenzene	<	5.2	<	6.0	44	6.2	6.1	6.0
Toluene	<	5.2	<	6.0	6.4	6.2	6.1	6.0
Xylenes, Total	<	5.2	<	6.0	41	6.2	6.1	6.0
Metals (mg/kg)								
Cadmium	<	0.26	<	0.30	<	0.31	<	0.30
Chromium	<	2.6	<	7.9	7.9	11.5	5.7	3.7
Lead		0.96	1.1	5.7	3.7	6.4	3.4	1.9
Mercury		0.13	0.14	0.55	1.4	1.4	<	0.12

J Positive result has been classified as qualitative.
 UJ Analyte was not detected or has been classified as undetected,
 with further classification as qualitative.
 U Reported or classified as undetected.
 R Analyte result has been classified as unusable.

Table 4.2
 Analytical Results for Soil Samples
 Collected in February 1994 at the MCI Site
 Tampa, Florida

Parameter	Sample No. Date Sampled	SS-14 2/23/94	SS-15 2/23/94	SS-16 2/23/94	DUPE A 2/23/94	SS-17 2/23/94	SS-18 2/23/94	SS-19 2/23/94
Volatile Organic Compound (ug/kg)								
cis-1,2-Dichloroethene	<	6.0 UJ	<	6.2 UJ	440 J	<	6.1 UJ	<
Benzene	<	6.0 UJ	<	6.2 UJ	1,500 J	<	6.1 UJ	<
Ethylbenzene	<	6.0 UJ	<	6.2 UJ	830 J	<	6.1 UJ	<
Toluene	<	6.0 UJ	<	6.2 UJ	420 J	<	6.1 UJ	<
Xylenes, Total	<	6.0 UJ	<	6.2 UJ	3700 J	<	6.1 UJ	<
Metals (mg/kg)								
Cadmium	<	0.3	<	0.31	<	0.30	<	0.31
Chromium	3.5	2.4 J	8.0	4.7	5.2	8.9	3.8	8.7
Lead	<	0.12	<	0.12	12.5 J	15.0 J	1.5 J	4.2 J
Mercury	<	0.12	<	0.12	17.1	<	0.13	0.16

J Positive result has been classified as qualitative.
 UJ Analyte was not detected or has been classified as undetected,
 with further classification as qualitative.
 U Reported or classified as undetected.
 R Analyte result has been classified as unusable.

Table 4.2
Analytical Results for Soil Samples
Collected in February 1994 at the MCI Site
Tampa, Florida

Parameter	Sample No. Date Sampled	SS-20 2/23/94	SS-21 2/23/94	SS-22 2/23/94	SS-23 2/24/94	SS-24 2/24/94	SS-25 2/24/94	SS-26 2/25/94						
Volatiles Organic Compound (ug/kg)														
cis-1,2-Dichloroethene	<	140 UJ	<	6.2 UJ	<	150 UJ	<	6.5 UJ	<	6.3	<	140	<	610
Benzene	<	140 UJ	<	6.2 UJ	<	150 UJ	<	6.5 UJ	<	6.3	<	140	<	610
Ethylbenzene	<	140 UJ	<	6.2 UJ	<	150 UJ	<	11	<	6.3	<	1,100	<	3,900
Toluene	<	140 UJ	<	6.2 UJ	<	150 UJ	<	6.5	<	6.3	<	11,000	<	610
Xylenes, Total	<	140 UJ	<	6.2 UJ	<	150 UJ	<	16	<	6.3	<	6,200	<	4500
Metals (mg/kg)														
Cadmium	<	0.30	<	0.31	<	0.31	<	0.32	<	0.31	<	0.31	<	0.3
Chromium		9.1	6.9	11.3	4.9	7.7	3.1	8.0		7.7		3.1		8.0
Lead		6.5 J	17.6 J	30.0 J	1.8	1.3	14.7	1.8		1.3		14.7		1.8
Mercury		0.33	0.79	0.16	0.13	0.13	0.20	0.13		0.13		0.20		0.13

J Positive result has been classified as qualitative.
 UJ Analyte was not detected or has been classified as undetected,
 with further classification as qualitative.
 U Reported or classified as undetected.
 R Analyte result has been classified as unusable.

Table 4.2
 Analytical Results for Soil Samples
 Collected in February 1994 at the MCI Site
 Tampa, Florida

Parameter	Sample No. Date Sampled	SS-27 2/28/94	DUP D 2/28/94	SS-28 2/24/94	DUP B 2/24/94	SS-29A 2/24/94	SS-29B 2/24/94	SS-30 2/24/94					
Volatiles Organic Compound (ug/kg)													
cis-1,2-Dichloroethene	<	6.5	<	6.4	<	5.7	<	5.7	<	5.9	R		
Benzene	<	6.5	<	6.4	<	5.7	<	5.7	<	5.9	R		
Ethylbenzene	<	6.5	<	6.4	<	5.7	<	5.7	<	5.9	R		
Toluene	<	6.5	<	6.4	<	9.5	J	5.7	<	5.8	R		
Xylenes, Total	<	6.5	<	6.4	<	5.7	<	5.7	<	5.7	R		
Metals (mg/kg)													
Cadmium	<	0.33	<	0.32	<	0.28	<	0.28	J	0.30	<	0.29	
Chromium		8.5		8.3		14.9	J	2.8	J	25.2		16.0	
Lead		3.4	J	2.6	J	1.4		2.4		113		21.1	
Mercury		0.41		0.30		0.26	J	0.11	J	27.3	J	1.6	J

J Positive result has been classified as qualitative.
 UJ Analyte was not detected or has been classified as undetected,
 with further classification as qualitative.
 U Reported or classified as undetected.
 R Analyte result has been classified as unusable.

Table 4.2
 Analytical Results for Soil Samples
 Collected in February 1994 at the MCI Site
 Tampa, Florida

Parameter	Sample No. Date Sampled	SS-31 2/24/94	SS-35 2/25/94	SS-36A 2/25/94	SS-36B 2/25/94	SS-37 2/25/94	SS-38 2/25/94	SS-39 2/25/94									
Volatile Organic Compound (ug/kg)																	
cis-1,2-Dichloroethene	<	5.7	<	5.8	<	5.4	<	5.6	UJ	<	5.9	<	6.4	<	6.2		
Benzene	<	5.7	<	5.8	<	5.4	<	5.6	UJ	<	5.9	<	6.4	<	6.2		
Ethylbenzene	<	5.7	<	5.8	<	5.4	<	5.6	UJ	<	5.9	<	6.4	<	6.2		
Toluene	<	5.7	<	5.8	<	5.4	<	5.6	UJ	<	5.9	<	6.4	<	6.2		
Xylenes, Total	<	5.7	<	5.8	<	5.4	<	5.6	UJ	<	5.9	<	6.4	<	6.2		
Metals (mg/kg)																	
Cadmium	<	0.28	<	0.29	R	<	0.27	R	<	0.28	R	<	0.32	R	<	0.31	
Chromium		6.6	<	2.9	R		3.7	J		7.2	J		3.2			16.1	
Lead		2.8		0.43	J		18.7	J		4.1	J		0.57	J		11.5	
Mercury		1.2	J	<	0.12	UJ	1.2	J		0.17	J		<	0.13	J		0.35

J Positive result has been classified as qualitative.
 UJ Analyte was not detected or has been classified as undetected,
 with further classification as qualitative.
 U Reported or classified as undetected.
 R Analyte result has been classified as unusable.

Table 4.2
 Analytical Results for Soil Samples
 Collected in February 1994 at the MCI Site
 Tampa, Florida

Parameter	Sample No. Date Sampled	SS-40 2/25/94	SS-41 2/25/94	SS-42 2/28/94	SS-43 2/28/94	SS-44 2/28/94	SS-45 2/28/94	SS-46 2/28/94
Volatile Organic Compound (ug/kg)								
cis-1,2-Dichloroethene	<	130	< 6.1	< 5.9	< 1,200	< 6.2	< 5.9	< 6.0
Benzene	<	130	< 6.1	< 5.9	< 1,200	< 6.2	< 5.9	< 6.0
Ethylbenzene	<	130	< 6.1	< 5.9	7,700	< 6.2	< 5.9	< 6.0
Toluene	<	130	< 6.1	< 5.9	< 1,200	< 6.2	< 5.9	< 6.0
Xylenes, Total	620	<	< 6.1	< 5.9	35,000	<	<	<
Metals (mg/kg)								
Cadmium	<	0.29 R	< 0.30 R	< 0.30	< 0.30	< 0.31	< 0.30	< 0.30
Chromium	10.9	9.7	7.8	5.2	12.4	7.7 J	7.9	11.8
Lead	3.1 J	9.6 J	10.2 J	3.4 J	7.7 J	13.2 J	13.2 J	3.0 J
Mercury	0.23 J	0.16 J	0.15	0.28	0.27	0.12	0.12	< 0.12

J Positive result has been classified as qualitative.
 UJ Analyte was not detected or has been classified as undetected,
 with further classification as qualitative.
 U Reported or classified as undetected.
 R Analyte result has been classified as unusable.

Wal-Mart Gunn Highway

MCI Till Area

Boring No.	109-SL-1	109-SL-6	109-SL-7	109-SL-8	Till-SL-1	Till-SL-2	Till-SL-3	Till-SL-4
Date	7/2/1998	7/2/1998	7/2/1998	7/2/1998	8/14/1998	8/14/1998	8/14/1998	8/14/1998
	mg/kg	mg/kg	mg/kg	mg/kg	mg/kg	mg/kg	mg/kg	mg/kg
SW846 8260								
1,2 Dichloropropane	0.052 U	0.052 U	0.053 U	0.052 U	0.058 U	0.056 U	0.059 U	0.054 U
Ehtylebnzene	0.052 U	0.052 U	0.053 U	0.052 U	0.058 U	0.056 U	0.059 U	0.054 U
Styrene	0.052 U	0.052 U	0.053 U	0.052 U	0.058 U	0.056 U	0.059 U	0.054 U
Tetrachloroethene	0.052 U	0.052 U	0.053 U	0.052 U	0.058 U	0.056 U	0.059 U	0.054 U
Toluene	0.052 U	0.16	0.14	0.11	0.058 U	0.056 U	0.059 U	0.054 U
1,1,1 Trichloroethane	0.052 U	0.052 U	0.053 U	0.052 U	0.058 U	0.056 U	0.059 U	0.054 U
Trichloroethene	0.052 U	0.052 U	0.053 U	0.052 U	0.058 U	0.056 U	0.059 U	0.054 U
Vinyl Chloride	0.1 U	0.1 U	0.11 U	0.1 U	0.120 U	0.110 U	0.120 U	0.110 U
Xylenes (Total)	0.052 U	0.052 U	0.053 U	0.052 U	0.058 U	0.056 U	0.059 U	0.054 U
Benzene	0.052 U	0.052 U	0.053 U	0.052 U	0.058 U	0.056 U	0.059 U	0.054 U
Carbon tetrachloride	0.052 U	0.052 U	0.053 U	0.052 U	0.058 U	0.056 U	0.059 U	0.054 U
1,2-Dichlorobenzene	0.052 U	0.052 U	0.053 U	0.052 U	0.058 U	0.056 U	0.059 U	0.054 U
1,4-Dichlorobenzene	0.052 U	0.052 U	0.053 U	0.052 U	0.058 U	0.056 U	0.059 U	0.054 U
1,2-Dichloroethane	0.052 U	0.052 U	0.053 U	0.052 U	0.058 U	0.056 U	0.059 U	0.054 U
1,1-Dichloroethene	0.052 U	0.052 U	0.053 U	0.052 U	0.058 U	0.056 U	0.059 U	0.054 U
cis-1,2-Dichloroethene	0.052 U	0.052 U	0.053 U	0.052 U	0.058 U	0.056 U	0.059 U	0.054 U
trans-1,2-Dichloroethene	0.052 U	0.052 U	0.053 U	0.052 U	0.058 U	0.056 U	0.059 U	0.054 U

TABLE 1
SUMMARY OF GROUND WATER QUALITY RESULTS
WAL-MART BROWNFIELDS GUNN HIGHWAY SITE

Monitor Well Designation	Sample Date	Parameter and Florida Class C-II Primary Ground Water Standard (62-210.420 FAC)													pH (Natural Background = 4.7 Minimum)					
		1	3	100	600	75	3	70	100	100	3	1000 (40)	200	3		1	10,000 (20)	4.7 Maximum		
		Benzene	Carbon Tetrachloride	Chlorobenzene	1,2-Dichlorobenzene	1,4-Dichlorobenzene	1,2-Dichloroethane	cis-1,2-Dichloroethene	trans-1,2-Dichloroethene	1,1-Dichloroethene	1,2-Dichloropropane	Biphenyls	Styrene	Tetrahydrofuran	Toluene	1,1,1-Trichloroethane	Trichloroethene	Vinyl Chloride	Xylenes, Total	
MW-144D	11/29/01	Well inaccessible due to site construction																		
	12/28/01	Well inaccessible due to site construction																		
	01/30/02	Well inaccessible due to site construction																		
	02/27/02	Well Destroyed																		
	11/28/01	<1.0	<3.0	<5.0	<5.0	<5.0	<5.0	<5.0	<5.0	<5.0	<5.0	<5.0	<5.0	<5.0	<5.0	<5.0	<5.0	<1.0	<5.0	NA
	12/28/01	<1.0	<3.0	<5.0	<5.0	<5.0	<5.0	<5.0	<5.0	<5.0	<5.0	<5.0	<5.0	<5.0	<5.0	<5.0	<5.0	<1.0	<5.0	NA
	01/30/02	<1.0	<3.0	<5.0	<5.0	<5.0	<5.0	<5.0	<5.0	<5.0	<5.0	<5.0	<5.0	<5.0	<5.0	<5.0	<5.0	<1.0	<5.0	NA
	02/27/02	<1.0	<3.0	<5.0	<5.0	<5.0	<5.0	<5.0	<5.0	<5.0	<5.0	<5.0	<5.0	<5.0	<5.0	<5.0	<5.0	<1.0	<5.0	4.85
	04/03/02	<1.0	<3.0	<5.0	<5.0	<5.0	<5.0	<5.0	<5.0	<5.0	<5.0	<5.0	<5.0	<5.0	<5.0	<5.0	<5.0	<1.0	<5.0	4.74
	05/01/02	<1.0	<3.0	<5.0	<5.0	<5.0	<5.0	<5.0	<5.0	<5.0	<5.0	<5.0	<5.0	<5.0	<5.0	<5.0	<5.0	<1.0	<5.0	5.31
05/31/02	<1.0	<3.0	<5.0	<5.0	<5.0	<5.0	<5.0	<5.0	<5.0	<5.0	<5.0	<5.0	<5.0	<5.0	<5.0	<5.0	<1.0	<5.0	4.67	
06/28/02	Abandoned																			
11/29/01	<1.0	<3.0	<5.0	<5.0	<5.0	<5.0	<5.0	<5.0	<5.0	<5.0	<5.0	<5.0	<5.0	<5.0	<5.0	<5.0	<1.0	<5.0	NA	
12/28/01	<1.0	<3.0	<5.0	<5.0	<5.0	<5.0	<5.0	<5.0	<5.0	<5.0	<5.0	<5.0	<5.0	<5.0	<5.0	<5.0	<1.0	<5.0	NA	
01/30/02	Well destroyed during site construction																			
11/29/01	<1.0	<3.0	<5.0	<5.0	<5.0	<5.0	<5.0	<5.0	<5.0	<5.0	<5.0	<5.0	<5.0	<5.0	<5.0	<5.0	<1.0	<5.0	NA	
12/28/01	<1.0	<3.0	<5.0	<5.0	<5.0	<5.0	<5.0	<5.0	<5.0	<5.0	<5.0	<5.0	<5.0	<5.0	<5.0	<5.0	<1.0	<5.0	NA	
01/30/02	<1.0	<3.0	<5.0	<5.0	<5.0	<5.0	<5.0	<5.0	<5.0	<5.0	<5.0	<5.0	<5.0	<5.0	<5.0	<5.0	<1.0	<5.0	NA	
02/27/02	<1.0	<3.0	<5.0	<5.0	<5.0	<5.0	<5.0	<5.0	<5.0	<5.0	<5.0	<5.0	<5.0	<5.0	<5.0	<5.0	<1.0	<5.0	6.19	
04/03/02	<1.0	<3.0	<5.0	<5.0	<5.0	<5.0	<5.0	<5.0	<5.0	<5.0	<5.0	<5.0	<5.0	<5.0	<5.0	<5.0	<1.0	<5.0	6.57	
05/01/02	<1.0	<3.0	<5.0	<5.0	<5.0	<5.0	<5.0	<5.0	<5.0	<5.0	<5.0	<5.0	<5.0	<5.0	<5.0	<5.0	<1.0	<5.0	6.50	
05/31/02	<1.0	<3.0	<5.0	<5.0	<5.0	<5.0	<5.0	<5.0	<5.0	<5.0	<5.0	<5.0	<5.0	<5.0	<5.0	<5.0	<1.0	<5.0	6.50	
06/28/02	<1.0	<3.0	<5.0	<5.0	<5.0	<5.0	<5.0	<5.0	<5.0	<5.0	<5.0	<5.0	<5.0	<5.0	<5.0	<5.0	<1.0	<5.0	5.92	
08/01/02	<1.0	<3.0	<5.0	<5.0	<5.0	<5.0	<5.0	<5.0	<5.0	<5.0	<5.0	<5.0	<5.0	<5.0	<5.0	<5.0	<1.0	<5.0	5.66	
08/30/02	<1.0	<3.0	<5.0	<5.0	<5.0	<5.0	<5.0	<5.0	<5.0	<5.0	<5.0	<5.0	<5.0	<5.0	<5.0	<5.0	<1.0	<5.0	5.39	
09/30/02	<1.0	<3.0	<5.0	<5.0	<5.0	<5.0	<5.0	<5.0	<5.0	<5.0	<5.0	<5.0	<5.0	<5.0	<5.0	<5.0	<1.0	<5.0	5.88	
09/30/02	<1.0	<3.0	<5.0	<5.0	<5.0	<5.0	<5.0	<5.0	<5.0	<5.0	<5.0	<5.0	<5.0	<5.0	<5.0	<5.0	<1.0	<5.0	5.75	
10/30/02	<1.0	<3.0	<5.0	<5.0	<5.0	<5.0	<5.0	<5.0	<5.0	<5.0	<5.0	<5.0	<5.0	<5.0	<5.0	<5.0	<1.0	<5.0	5.93	
12/02/02	<1.0	<3.0	<5.0	<5.0	<5.0	<5.0	<5.0	<5.0	<5.0	<5.0	<5.0	<5.0	<5.0	<5.0	<5.0	<5.0	<1.0	<5.0	5.84	
11/29/01	<1.0	<3.0	<5.0	<5.0	<5.0	<5.0	<5.0	<5.0	<5.0	<5.0	<5.0	<5.0	<5.0	<5.0	<5.0	<5.0	<1.0	<5.0	NA	
12/28/01	<1.0	<3.0	<5.0	<5.0	<5.0	<5.0	<5.0	<5.0	<5.0	<5.0	<5.0	<5.0	<5.0	<5.0	<5.0	<5.0	<1.0	<5.0	NA	
01/30/02	<1.0	<3.0	<5.0	<5.0	<5.0	<5.0	<5.0	<5.0	<5.0	<5.0	<5.0	<5.0	<5.0	<5.0	<5.0	<5.0	<1.0	<5.0	NA	
02/27/02	<1.0	<3.0	<5.0	<5.0	<5.0	<5.0	<5.0	<5.0	<5.0	<5.0	<5.0	<5.0	<5.0	<5.0	<5.0	<5.0	<1.0	<5.0	6.79	
04/03/02	<1.0	<3.0	<5.0	<5.0	<5.0	<5.0	<5.0	<5.0	<5.0	<5.0	<5.0	<5.0	<5.0	<5.0	<5.0	<5.0	<1.0	<5.0	16	
05/01/02	<1.0	<3.0	<5.0	<5.0	<5.0	<5.0	<5.0	<5.0	<5.0	<5.0	<5.0	<5.0	<5.0	<5.0	<5.0	<5.0	<1.0	<5.0	5.65	
05/31/02	<1.0	<3.0	<5.0	<5.0	<5.0	<5.0	<5.0	<5.0	<5.0	<5.0	<5.0	<5.0	<5.0	<5.0	<5.0	<5.0	<1.0	<5.0	5.5	
06/28/02	<1.0	<3.0	<5.0	<5.0	<5.0	<5.0	<5.0	<5.0	<5.0	<5.0	<5.0	<5.0	<5.0	<5.0	<5.0	<5.0	<1.0	<5.0	3.28	
08/01/02	<1.0	<3.0	<5.0	<5.0	<5.0	<5.0	<5.0	<5.0	<5.0	<5.0	<5.0	<5.0	<5.0	<5.0	<5.0	<5.0	<1.0	<5.0	3.31	
08/30/02	<1.0	<3.0	<5.0	<5.0	<5.0	<5.0	<5.0	<5.0	<5.0	<5.0	<5.0	<5.0	<5.0	<5.0	<5.0	<5.0	<1.0	<5.0	3.67	
09/30/02	<1.0	<3.0	<5.0	<5.0	<5.0	<5.0	<5.0	<5.0	<5.0	<5.0	<5.0	<5.0	<5.0	<5.0	<5.0	<5.0	<1.0	<5.0	3.74	
10/30/02	<1.0	<3.0	<5.0	<5.0	<5.0	<5.0	<5.0	<5.0	<5.0	<5.0	<5.0	<5.0	<5.0	<5.0	<5.0	<5.0	<1.0	<5.0	4.05	
12/02/02	1.2	<3.0	<5.0	<5.0	<5.0	<5.0	<5.0	<5.0	<5.0	<5.0	<5.0	<5.0	<5.0	<5.0	<5.0	<5.0	<1.0	<5.0	4.63	
12/30/02	2.2	<3.0	<5.0	<5.0	<5.0	<5.0	<5.0	<5.0	<5.0	<5.0	<5.0	<5.0	<5.0	<5.0	<5.0	<5.0	<1.0	<5.0	5.02	
02/03/03	1.1	<3.0	<5.0	<5.0	<5.0	<5.0	<5.0	<5.0	<5.0	<5.0	<5.0	<5.0	<5.0	<5.0	<5.0	<5.0	<1.0	<5.0	NR	
03/14/03	1.8	<3.0	<5.0	<5.0	<5.0	<5.0	<5.0	<5.0	<5.0	<5.0	<5.0	<5.0	<5.0	<5.0	<5.0	<5.0	<1.0	<5.0	4.99	
03/14/03	1.3	<3.0	<5.0	<5.0	<5.0	<5.0	<5.0	<5.0	<5.0	<5.0	<5.0	<5.0	<5.0	<5.0	<5.0	<5.0	<1.0	<5.0	5.06	
04/29/03	damaged	not sampled																		
06/17/03	1.9	<3.0	<5.0	<5.0	<5.0	<5.0	<5.0	<5.0	<5.0	<5.0	<5.0	<5.0	<5.0	<5.0	<5.0	<5.0	<1.0	<5.0	6.65	
07/01/03	2.3	<3.0	<5.0	<5.0	<5.0	<5.0	<5.0	<5.0	<5.0	<5.0	<5.0	<5.0	<5.0	<5.0	<5.0	<5.0	<1.0	<5.0	6.63	
08/04/03	damaged	not sampled																		
09/24/03	damaged	not sampled																		
10/31/03	damaged	not sampled																		
12/01/03	paved over																			
12/01/03	paved over																			
12/01/04	7.3	<0.42	<0.63	<0.44	<0.52	<0.57	<0.65	<0.44	<0.44	<0.45	<0.52	<0.44	<0.38	<0.34	<0.51	<0.46	<0.28	<0.50	<0.98	4.54
06/30/05	18	<0.42	<0.63	<0.44	<0.52	<0.57	1.5	<0.44	<0.44	<0.45	<0.52	<0.44	<0.38	<0.34	<0.51	<0.46	<0.28	<0.50	1.9	4.56
12/29/05	2.9	<0.42	<0.63	<0.44	<0.52	<0.57	<0.65	<0.44	<0.44	<0.45	<0.52	<0.44	<0.38	<0.34	<0.51	<0.46	<0.28			

